

ECK-Lautsprecher

- edles Aluminiumgehäuse für direkte Eckmontage 90°
- Befestigungen sind nicht sichtbar
- diverse Audio-Anschlüsse unten/oben jeweils im Eckbereich
- geeignet für Beschallung und Installation:
- Messen, Bistro, Café, unter Balkon, Home-Cinema...

CORNEREDAUDIOSYSTEMS

click to -Manual- laden aus [www. http://www.cornered.dk](http://www.cornered.dk)



Artikel Nr.:	Model	Beschreibung	Anschlüsse	Finish	Preise in EUR
70601	C6TRM	Top-box	Speakon	Black	378,-
70602	C6TRM	Top-box	Speakon	White	398,-
70603	C6TRM	Top-box	Speakon	Aluminium	388,-
70604	C6TRM	Top-box	XLR	Black	388,-
70605	C6TRM	Top-box	XLR	White	408,-
70606	C6TRM	Top-box	XLR	Aluminium	398,-
70607	C6TRM	Top-box	Screw term.	Black	358,-
70608	C6TRM	Top-box	Screw term.	White	368,-
70609	C6TRM	Top-box	Screw term.	Aluminium	378,-
70501	C6	Top-box	Speakon	Black	340,-
70502	C6	Top-box	Speakon	White	360,-
70503	C6	Top-box	Speakon	Aluminium	352,-
70504	C6	Top-box	XLR	Black	350,-
70505	C6	Top-box	XLR	White	370,-
70506	C6	Top-box	XLR	Aluminium	362,-
70507	C6	Top-box	Screw term.	Black	330,-
70508	C6	Top-box	Screw term.	White	350,-
70509	C6	Top-box	Screw term.	Aluminium	342,-
60301	C12PNC	Subwoofer	Screw term.	Black leather	680,-
6030**	C12PNC	Subwoofer	Screw term.	RAL-Colour Leder	690,-

· C6TRM werden nur paarweise geliefert | · Ab Lager Hofheim | · Preise=Einzelpreise
 · Alle Preise in EUR verstehen sich zzgl. der gesetzlichen MwSt. |

12"Subwoofer als Sitzpolster mit Nappaleder

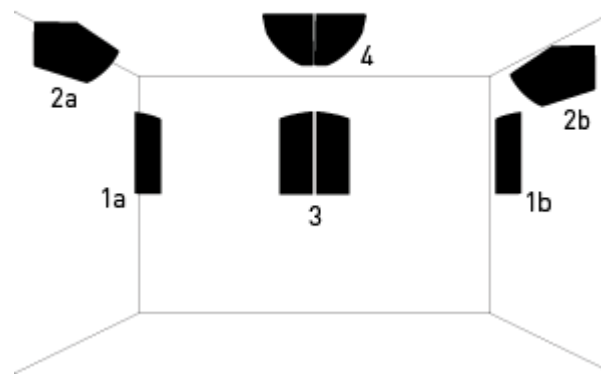

Technische Daten

Power handling, IEC268:
 Power handling, peak:
 Sensitivity, 2,83V/1m:
 Maximum SPL, long term:
 Maximum SPL, peak:
 Freq. response, +/- 3 dB:
 Nominal impedance:
 Recommended amplifier:
 Rec. high-pass filter:
 Weight:
 Measurements (HxWxD):
 Finish:
 Input connectors:

C6TRM

250 watt
 1000 watt
 91 dB
 115 dB
 121 dB
 80-16.000 Hz
 8 ohm
 350 watt into 8 ohm
 80 Hz/24dB LR
 5.7 kg/14,5 lbs.
 50,2 x 23,2 x 15,5 cm
 (19,8 x 9,1 x 6,1 in)
 Black, white or aluminium
 Speakon NL4, XLR or screw terminal

C6

150 watt
 600 watt
 91 dB
 112 dB
 118 dB
 80-20.000 Hz
 8 ohm
 200 watt into 8 ohm
 80 Hz/24dB
 5 kg/12,7 lbs.
 50,2 x 23,2 x 15,5 cm
 19,8 x 9,1 x 6,1 in
 Black, white or aluminium
 Speakon NL4, XLR or screw terminal

Technische Daten

Woofer:
 Nominal impedance:
 Power rating AES:
 Power rating peak:
 Sensitivity 1w/1m:
 Maximum SPL, calculated:
 Maximum SPL, peak:
 Frequency range(+/-3dB):
 Physical:
 Dimensions (HxWxD):
 Net weight:
 Grille:
 Input connectors:
 Finish:

C12PNC

12"
 8 ohm
 500 watt
 2000 watt
 95 dB
 122 dB
 128 dB
 48 Hz-900 Hz
 43x43x43 cm
 25 kg / 55 lbs
 1,5 mm steel, foam covered
 Barrier strip terminal
 Upholstered black Napa or custom finish on request

Installing the speaker

Although the CORNORED top-boxes are very light, before installing the speaker make sure that the wall structure is solid and can support the weight of the speaker. Also, make sure that you comply with all local health and safety regulations.

As the speaker is pre-angled and cannot be tilted when mounted flush against a wall or ceiling, coverage can be adjusted by positioning the cabinet higher or lower in the room away from the corner, until the desired coverage is obtained. This can also be done when installing only one speaker horizontally as described below.

Corner position

1. Remove grille

Press one side of the grille downward and out
Grille will become loose and can be removed

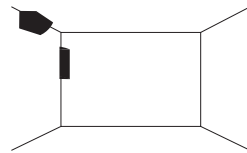

Push the edge of the grille down and out

2. Place speaker at desired position
3. Mark drilling positions on wall by shading through the four mounting holes behind the grille
4. Drill holes in wall (if the speaker is equipped with a barrier strip cable terminal, connect the cables at this time)
5. Reposition speaker at desired position and mount the screws



6. Reinstall grille

Place one side of the grille in the groove in the cabinet's side
Press the grille together so that the other side slides into the groove



Do not push the grille down into the groove in which it is mounted. Unlike traditional grilles, the grille has to be pulled out towards the front of the groove in order to make sure that the woofer will not touch the grille when moving at maximum excursion



7. Insert Speakon or XLR cable into either side of the speaker
8. If needed, use the other Speakon or XLR plug to link other speakers



All CORNORED top-boxes are 8 ohm and as such a typical amplifier will allow for three top-boxes to be linked per amplifier channel. Refer to the minimum required impedance of the amplifier.

One speaker vertical on wall

1. Remove grille
Press one side of the grille downward and out
Grille will become loose and can be removed
2. Place speaker at desired position
3. Mark drilling positions on wall using only two of the mounting holes at the side of the cabinet
4. Drill holes in wall (if the speaker is equipped with a barrier strip cable terminal, connect the cables at this time)
5. Reposition speaker at desired position and mount the screws
6. Reinstall grille
Place one side of the grille in the groove in the cabinet's side
Press the grille together so that the other side slides into the groove
7. Insert Speakon or XLR cable into either side of the speaker

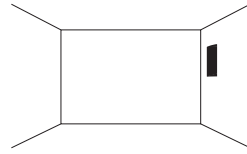

Two speakers vertical or horizontal on wall or ceiling

1. Repeat steps 1 to 4
2. Screw the cabinets together using the two bolts supplied

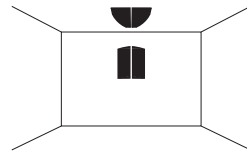

3. Repeat steps 5 to 7

One speaker horizontal on wall

If a given installation calls for one speaker to be mounted horizontally on the wall, this can be done by the use of a small bracket as described below:

1. Remove grille
Press one side of the grille downward and out
Grille will become loose and can be removed
2. Place speaker at desired position
3. Mark drilling positions on wall using only the two lower mounting holes at the side of the cabinet
4. Drill holes in wall
5. Mark mounting position on wall through the bracket holes. Mount bracket on wall. (if the speaker is equipped with a barrier strip cable terminal, connect the cables at this time)
6. Reposition speaker at desired position and mount the screws into the wall. After that connect the cabinet to the bracket by placing the nut on top of the bracket and mounting the bolt through the cabinet mounting holes and into the nut

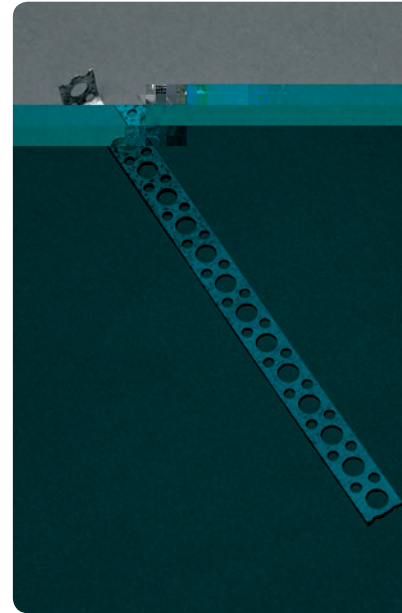
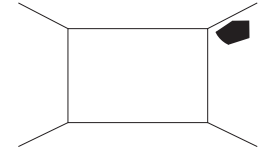

7. Reinstall grille
8. Insert Speakon or XLR cable into either side of the speaker

Installation hint



If the corner is more than 90 degree or if cables or lists takes up space behind the cabinet, not allowing it to come flush with wall or ceiling, simply leave some space between the speaker cabinet and either wall or ceiling by placing a small washer.

Connection

CORNORED top-boxes are available with either XLR/Speakon plugs or barrier strip terminals:

- a. The Speakon version is recommended when the product is used in a non-fixed installation such as low-level stage monitoring, broadcast, etc.
- b. The XLR version is recommended in applications where the speaker cable is located externally on the wall or ceiling. Being smaller and more elegant than the Speakon plug, the XLR connector will become part of the design when mounted into the cabinet.
- c. The barrier strip terminal is recommended in applications where the cable is hidden inside the wall or ceiling and emerges directly behind the speaker cabinet. In this application there are no visible speaker terminals when the speaker is installed.

Connect a Speakon plug

The Speakon pin configuration is standard. Plus (+) is connected to 1+ in the Speakon socket and minus (-) is connected to 1- in the Speakon socket. Simply insert the plug and turn it to the right until you hear or feel it click into the Speakon socket. To remove the Speakon connector, pull back the metal bar, turn the plug to the left and pull it out.

Connect an XLR plug

The XLR pin configuration is standard. Plus (+) is connected to 2 in the XLR socket and minus (-) is connected to 1 in the XLR socket. Simply insert the XLR connector into the XLR socket until you hear or feel it click. To remove the XLR connector, push the metal bar on the socket down and pull out the XLR connector.

Connect to the barrier strip terminal

The barrier strip terminal will accept bare wire or a U-type cable shoe (ill. x). To ensure correct polarity, make sure that + (red) on the amplifier output is connected to + on the barrier strip terminal and that - (black) on the amplifier output is connected to - on the barrier strip terminal.

Recommended speaker cables

Speaker cables present the amplifier with different loads. Cables with high capacitance, high inductance and high impedance have a strong negative influence on sound quality as well as amplifier reliability, so in order to get the most out of the speaker system, avoid using thin speaker cables.

As a rule of thumb, 2 mm² (14 AWG) cable can be used for lengths up to 20 meters. 4 mm² (11 AWG) cable should be used for lengths over 20 meters. For lengths over 50 meters, most amplifiers will become unstable and sound quality is reduced significantly.

Safety wire

In installation terms, the CORNORED top-boxes are 'as much brackets as they are speakers,' so no safety wire is needed, just as you wouldn't need a safety wire from the wall to a bracket. However, if required, simply attach the wire to one of the top plate screws.

Warranty

For warranty information, please refer to your local CORNORED distributor or dealer.

Service

Spare parts for your CORNORED speakers are available through your local CORNORED distributor. In case you are not able to source spare parts locally, please contact us directly at info@CORNORED.com.

Specifications

▲ Power handling, IEC268:	250 watt
▲ Power handling, peak:	1000 watt
▲ Sensitivity, 2,83V/1m:	91 dB
▲ Maximum SPL, long term:	115 dB
▲ Maximum SPL, peak:	121 dB
▲ Freq. response, +/- 3 dB:	80-16.000 Hz
▲ Nominal impedance:	8 ohm
▲ Recommended amplifier:	350 watt into 8 ohm
▲ Rec. high-pass filter:	80 Hz/24dB
▲ Weight:	5.7 kg/14,5 lbs.
▲ Measurements (HxWxD):	50,2 x 23,2 x 15,5 cm/19,8 x 9,1x 6,1 in
▲ Finish:	Black, white or aluminum
▲ Input connectors:	Speakon NL4, XLR or barrier strip terminal

Front

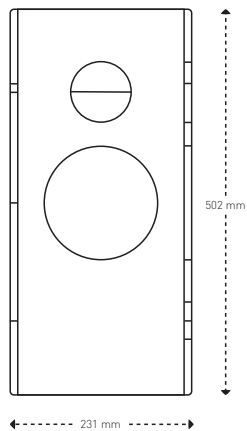

Top plate

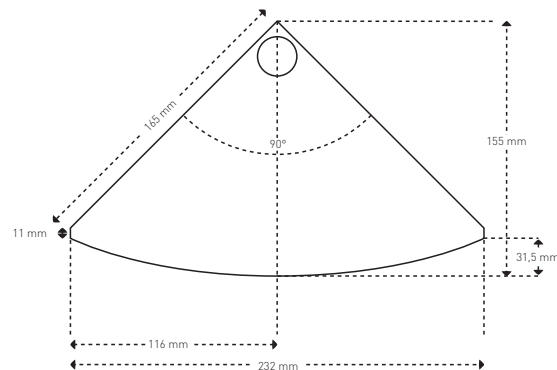

Declaration of conformity

Manufacturer:

CORNORED Audio Systems
Roskildevej 16A
2620 Albertslund
Denmark
Tel/fax: +45 86 180017
<http://www.cornored.com>

We, CORNORED Audio Systems, declare under our responsibility that the following product(s):

C6, C6TRM, Type: Speaker

...are in conformity with COUNCIL DIRECTIVE of 3 May 1989 on the approximation of the laws of the Member States relating to electromagnetic compatibility (89/336/EEC) and has been manufactured in conformity with the following national standards that implements a harmonized standard:

EN 55013

Limits and methods of measurement of radio disturbance characteristics of broadcast receivers and associated equipment.

Hans V. Madsen
Date: 14-01-2006

Contents of the manual are subject to change without notice. CORNORED Audio Systems does not accept any liability for loss or damage caused or alleged to be caused directly or indirectly by these instructions. CORNORED Audio Systems makes no guarantee of any kind with regard to these instructions.